

"Dealing with climatic changes (including sea level rise)... is a flexible process that will never end any more. We will have to adapt again and again." - Piet Dircke



west coast



bay area



mission bay



past : water-filled

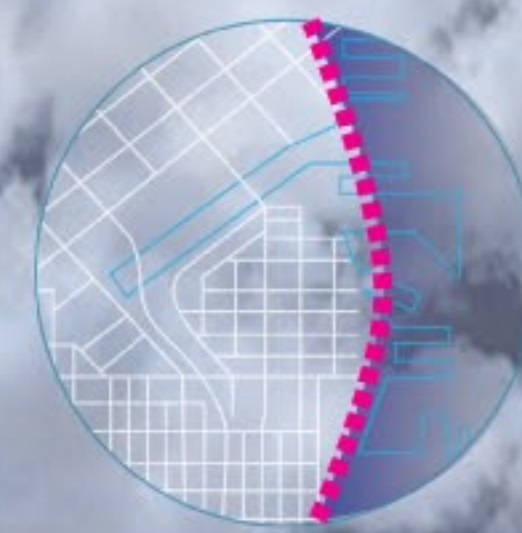

present : land-filled



future : planned acceptance



future : a new network



# embracing the rise

## multiple adaptations to the living edge



blue conveyor

**Embracing the Rise** opens the dialogue for communities around the world to identify, respond and adapt to their particular situation. We present a model for first steps as well as long term transformation. Getting ahead of the problem we exhort communities to:

### Reconsider the Ground Plane : a blue topography

At the heart of the matter is the relationship between ground plane and the water's edge. Embracing the Rise breaks down our conception of the edge through the manipulation of the ground plane as a means to direct and mobilize water, a key resource for urban communities and natural ecologies.

A new three dimensional network is overlaid on the conventional grid, sculpting new waterways or "blue streets" to introduce the tide, and strategically and selectively raising others to protected high ground. To enable this re-conception of the edge, existing infrastructure is transformed into a sound/waterproofed vital line collector of both access and utilities.

### Mobilize Water : a blue conveyor

First steps can mobilize water as a strategic change agent and a catalyst for decentralized infrastructure. Natural resources must be localized within urban centers. Resources such as food, water (potable, fresh and salt), and sustainable energy generation can become part of a new decentralized "soft infrastructure".

Matched by local perception and innovation, urban centers will generate their own sustenance in a resource challenged future. Shorelines, that over history had become subject to fill or disturbance, will simultaneously begin their healing process and adaptation of habitats - for all species. As such, the blue conveyor recognizes and spotlights fundamental changes essential at the coast. Embracing the Rise envisions a new ecosystem using water as a central resource.

### Advance Symbiotic Structures : a blue framework

"Soft Infrastructure" provides a foundation which allows for a long term transformation of reference planes. Slowly, the ground will respond to the rise, reshaping the surface, redefining the interface with structures and associated movements/access, allowing for new species to thrive.

Looking ahead, we envision innovative typologies responsive to site and program specifics that will be ready to "plug" into this new infrastructure. A vertical plug might well include reuse/additive/symbiotic use of existing buildings as floating or energy access for new programmable high ground. A horizontal plug invites floating, modular, nomad architectures seeking sustenance, triggering social interaction and providing new living or working opportunities.

## Armature

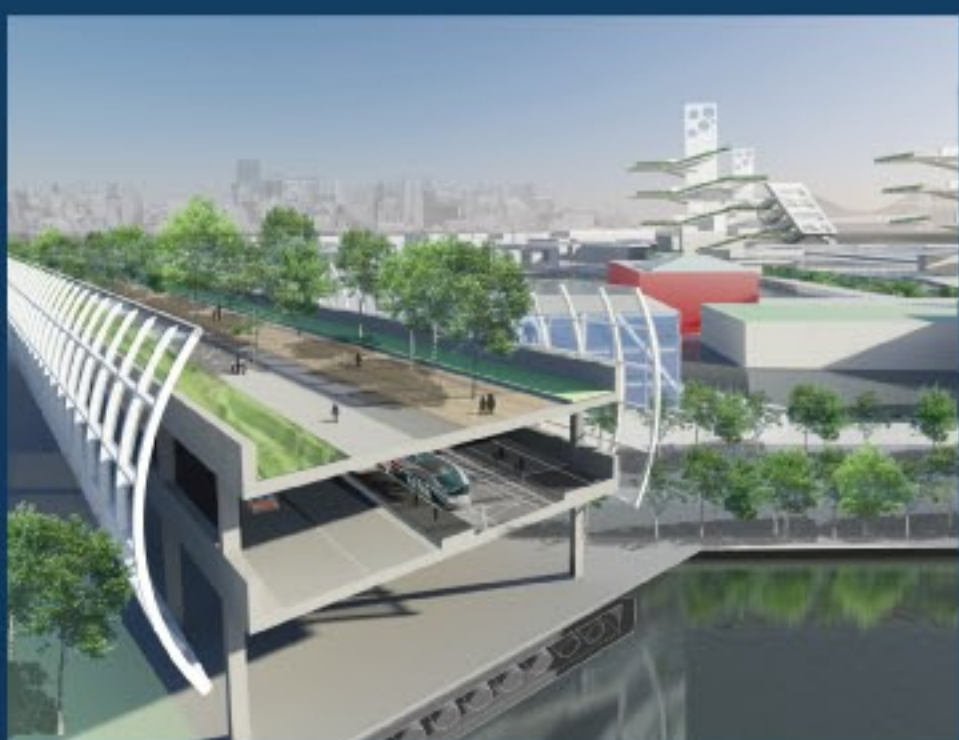

**Armature** : stacking the city's vital connections through modular encasements that can be easily updated, dismantled and reconfigured for flexible adaptations.

Green & Blue : Wrapping the vitals in a soft tissue of landscape elements that enable the type to double its function as a carbon sink and energy generator.

## Symbio



**Symbio** : encasing and rewiring existing buildings for a symbiotic relationship with a host structure through clipped program and elevated commons.

Green & Blue : embryonic mutation that pairs vascular properties to filter water through vertical sequencing, providing desalinating and aquaculture function.

## Fold



**Fold** : folding and unfolding the ground plane to increase surface areas for high-intensity agricultural production, water purification, sustainable energy production and occupation.

Green & Blue : residential focus that melds landscape through living quarters, staircasing around an open-air atrium. Commons enclosed in a green skin.

## Nomad

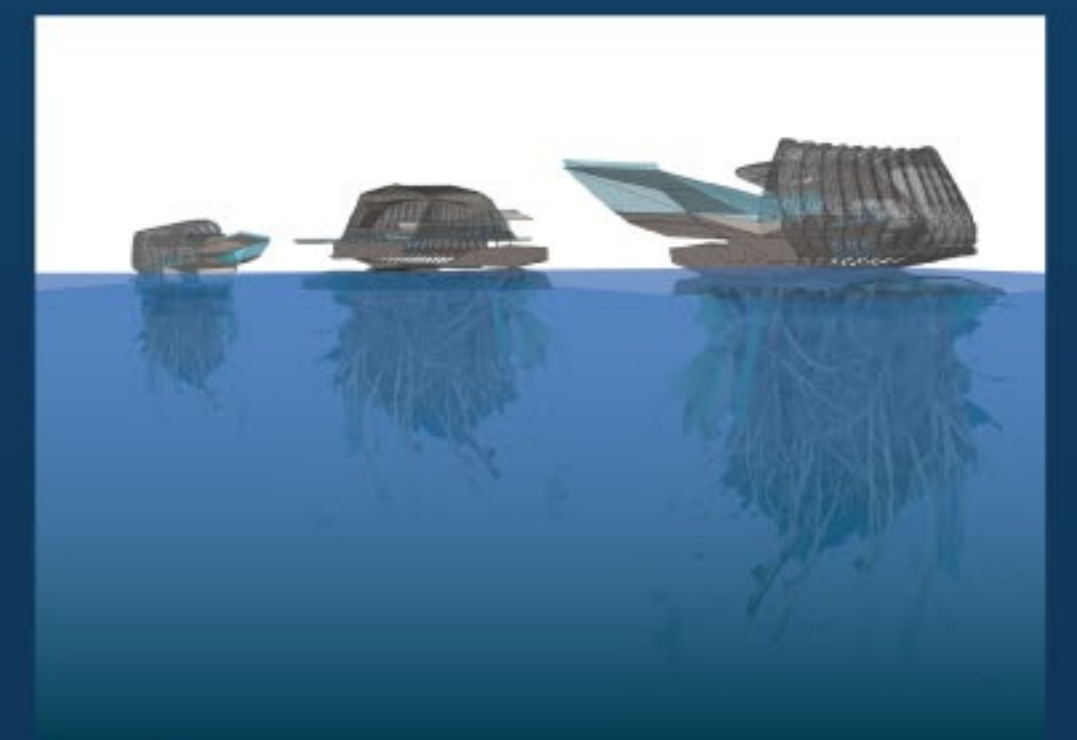

**Nomad** : a buoyant, movable, flexible adaptation attuned to self-sustaining to wet shoreline conditions as well as being in isolation atop the ocean level.

Green & Blue : a transportable water tight box that enables rapid deployment to areas that are in urgent need of shelter and basic sustenance.

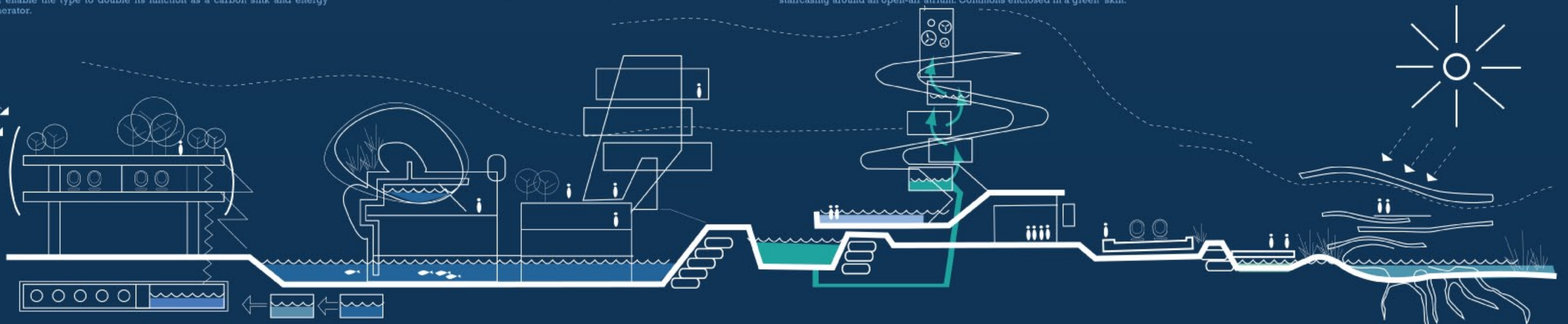

I-280 : fortifying the edge while enhancing connections

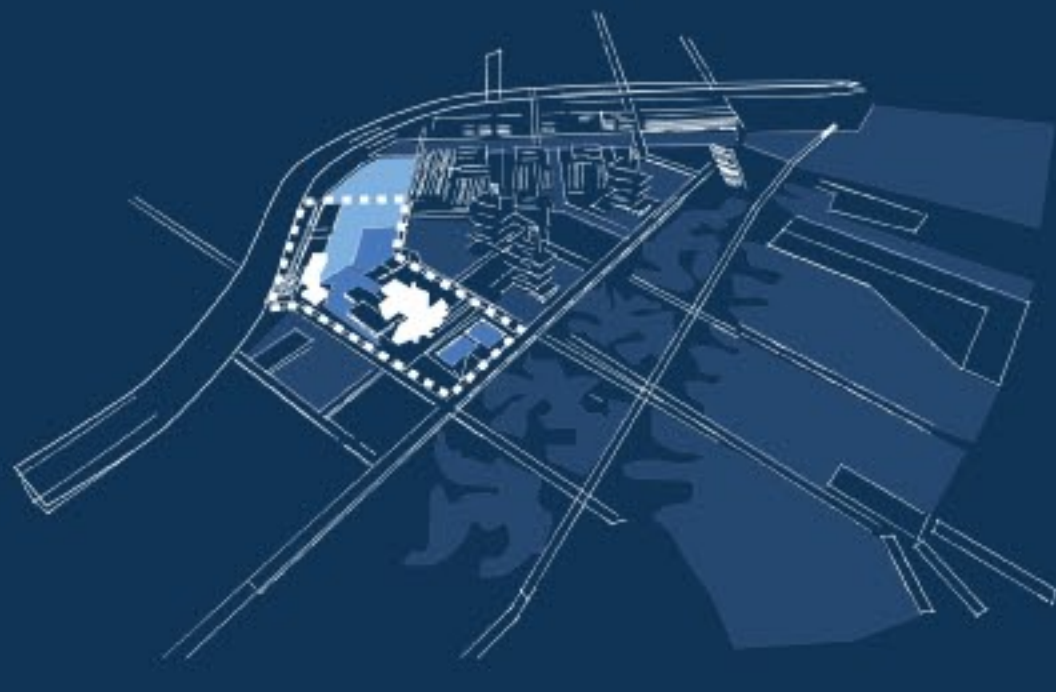

UCSF : a new interpretation of the campus core



3rd street : an iconic interface and frontage to the bay



Bay Trail : a datum to the undulating wetland edge